

SINGLE ACTING PNEUMATIC CYLINDERS ISO 21287 COMPACT



Compact cylinders are smaller than standard cylinders and they are suitable especially, when there isn't enough space for standard cylinder. Dimensions of mounting holes meets international standards ISO 21287, ISO 6431, VDMA 24562 and NF E 49003.1, that is why standard mounting accessories can be used. Cylinders aren't equipped with cushioning.

Working pressure	0.6 MPa
Min. pressure	0.15 MPa
Max. pressure	1.0 MPa
Temp. range	-20°C to +80°C
Working medium	modified compressed air

Piston diameter [mm]	32	40	50	63	80	100
Thrust at 0.6 MPa [N]*	482	754	1178	1870	3015	4713
Return force at 0.6 MPa [N]*	415	662	1025	1717	2720	4487
Spring restoring force [N]	17	24	22	42	33	120
Connection	G1/8"	G1/8"	G1/8"	G1/8"	G1/8"	G1/8"
Max. stroke [mm]	25	25	40	50	50	50
Weight 0 mm stroke [kg]	0.25	0.34	0.51	0.75	1.23	1.99
Weight add. per 1 mm stroke [kg]	0.0030	0.0034	0.0047	0.0055	0.0076	0.0095

*) Cylinder will make out either thrust or return force, accordingly to the type (spring return / extend).

Order codes

12105 10 00 050 0010

Type		Equipment		Options		Piston diameter		Stroke / Repair kit	
12105	compact single acting, spring return	00	w/o magnet, external thread	00	without options	032	32 mm	xxxx	mm of stroke e.g.: 0010 = stroke 10 mm
12106	compact single acting, spring extend	01	w/o magnet, internal thread	14	1.4301 stainless steel piston rod	040	40 mm	9999	repair kit
		10	with magnet, external thread	16	steel parts from stainless 1.4301 piston rod stainless 1.4401	050	50 mm		
		11	with magnet, internal thread			063	63 mm		
						080	80 mm		
						100	100 mm		

For more options regarding materials or dimensions, please contact our technical dept.

Construction / materials

- caps: drawn dural profile, anodized
- body: drawn dural profile, anodized
- piston rod: grounded round steel bar CK45 with hard chrome plated surface

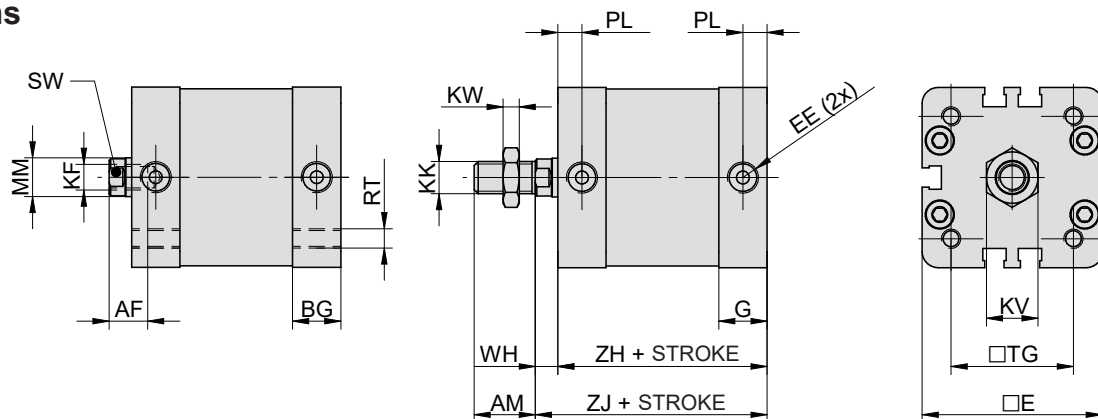
Dimensions

∅	AF	AM	BG	E	EE	G	KF	KK	KV	KW	MM	PL	RT	SW	TG	WH	ZH	ZJ
32	12	19	14.5	49.2	G1/8"	14,5	M8	M10x1.25	16	5	12	7.5	M6	10	32.5	7	52*	59*
40	12	19	15	56	G1/8"	15	M8	M10x1.25	16	5	12	7.5	M6	10	38	7	45	52
50	16	22	15	69	G1/8"	15	M10	M12x1.25	18	6	16	7.5	M8	13	46.5	8	45	53
63	16	22	15	79	G1/8"	15	M10	M12x1.25	18	6	16	7.5	M8	13	56.5	8	49	57
80	20	28	17	95	G1/8"	17	M12	M16x1.5	24	8	20	7.5	M10	16	72	10	54	64
100	20	28	20	115.5	G1/8"	20	M12	M16x1.5	24	8	20	7.5	M10	16	89	10	67	77

*) Dimensions ZH and ZJ of dia. 32 mm do not follow ISO 21287 standard.

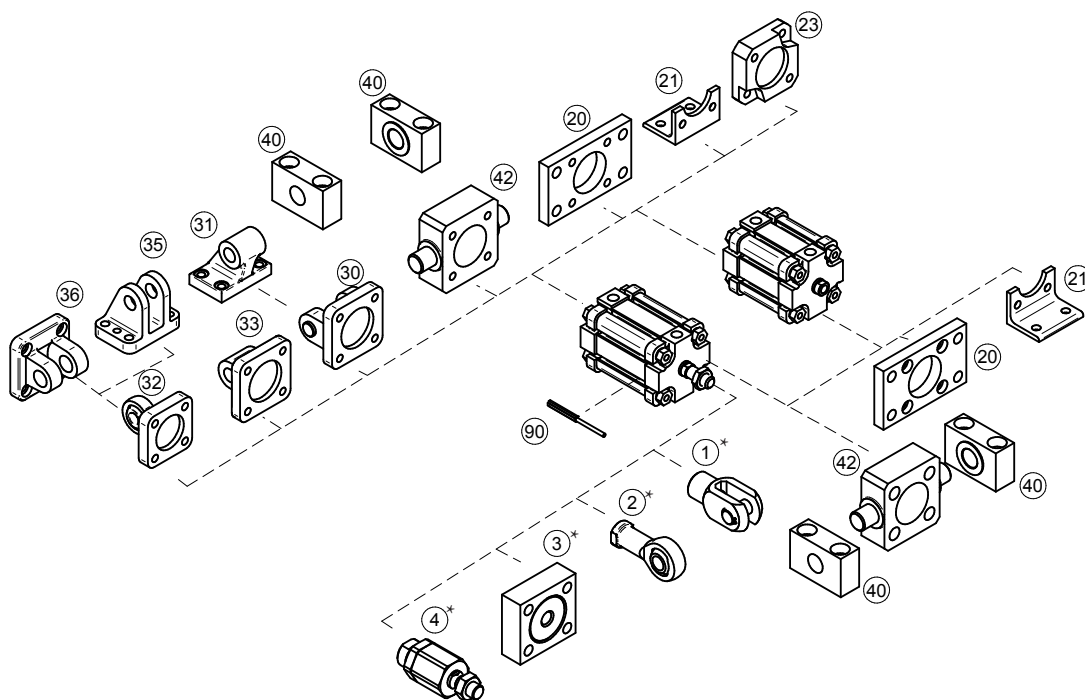
Mounting accessories

Mounting accessories	... see page
1 Piston rod clevis*	... 4-2
2 Piston rod eye*	... 4-3
3 Flanged piston rod coupling*	... 4-2
4 Self-aligning piston rod coupling*	... 4-3
20 Flange mounting	... 4-6
21 Foot mounting	... 4-4
23 Boxer flange mounting	... 4-22
30 Swivel flange	... 4-8
31 Clevis foot mounting	... 4-8
32 Swivel flange with spherical bearing	... 4-10
33 Swivel flange	... 4-7
34 Narrow swivel flange	... 4-9
35 Rectangular swivel flange	... 4-9
40 Trunnion mounting	... 4-12
42 Pivot pin to front/end cap	... 4-12
90 Prox. switch	... 3-2, 3-4
90 Proportional position sensor with analog output	... 3-6

*) Please check dimensions of thread on cylinder and accessories for piston rod, before you order it (for example: compact cylinder piston dia. 40 mm has thread M10x1.25 on piston rod, piston rod clevis for cylinder dia. 40 has thread M12x1.25, so it is necessary to order piston rod clevis for cylinder dia. 25/32, where is thread M10x1.25).